

General Notes:

- Elevations shown in NAVD1988
- Only visible utilities shown
- Contractor is to visit site and verify all existing conditions (including underground utilities, pipes, etc)
- Verification and field marking of location of existing utilities is required prior to commencement of work and is the responsibility of the contractor
- Any damage of disturbance to existing utilities during the duration of the contract is to be repaired/replaced 'in kind' by the contractor at his own expense
- Survey performed with heavy snow cover. Not all features might be shown.

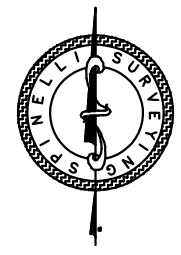

Survey of Lots 23 and 26 as shown on
 "Map of Woodbine Park, Village of Larchmont,
 Westchester County, New York"
 Filed on March 28, 1890 as Map No. 926

Scale 1"=15' January 7, 2010
 Dec. 30, 2015 (Updated)
 May 13, 2019 (Updated)
 Feb. 17, 2021 (Add Topo)
 April 13, 2021 (revised)

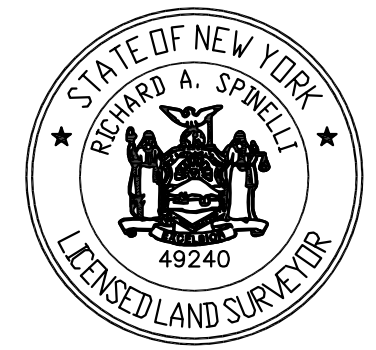

Richard A. Spinelli
 Richard A. Spinelli
 650 Halstead Avenue
 Mamaroneck, N. Y. 10543
 (914) 381-2357
 N.Y.S. Lic. Land Surveyor
 No. 49240